

Manual of the TV system in your complex

Package contents



The settopbox (MAG 420)



Connect settopbox

- Connect one side of the supplied HDMI cable to the settopbox, the other side to a free HDMI port on the TV.
- Connect the RJ-45 network cable to the network port on the settopbox, the other side to port 2 on the modem
- Finally, connect the power supply.

The settopbox starts up. After about 1 minute a TV channel will be shown.

Use of the system

After start-up, the system is ready for use and you can "zap" directly through all available TV channels. You operate the system with the supplied remote control, the main buttons are:

- The red standby button: switch the settopbox on or off (standby). Note: the settopbox is on when the standby LED is dimmed. The settopbox is off when the LED is bright.
- The oval "switch channels" button. Zaps all available TV channels.
- The oval "volume" button. Increase or decrease the volume.
- Do you know the exact number of the channel you would like to watch? Then use the number keys.

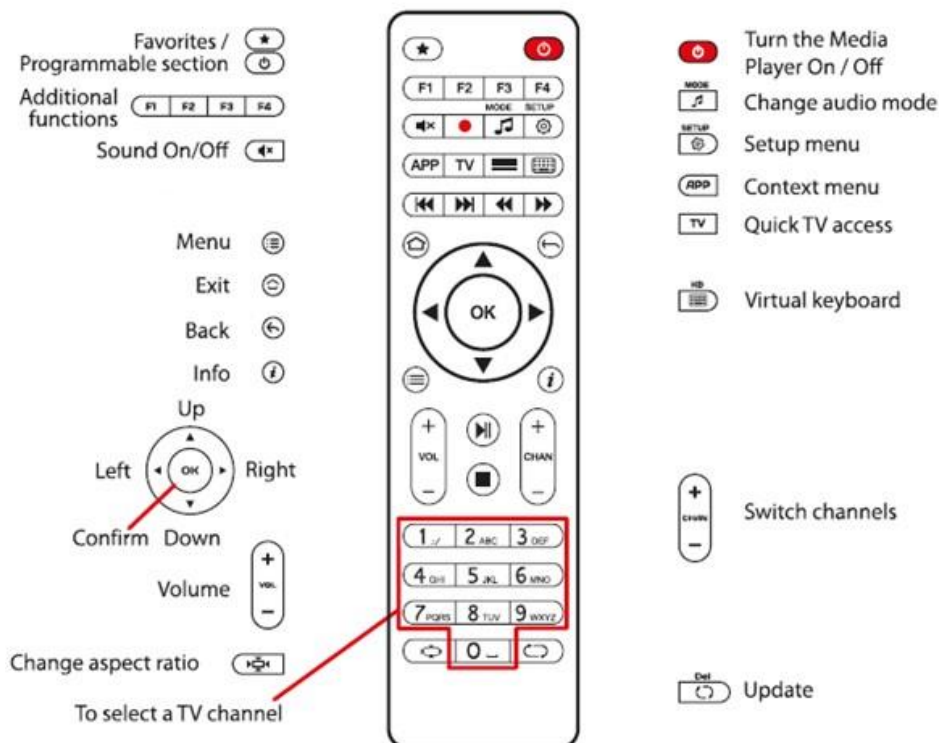

Teletext / subtitles

Activating subtitles on Dutch broadcasting and commercial programs. *This must be done once or after a complete power interruption of the settopbox.*

- Tune to the channel where subtitles are desired.
- Press OK once. A selection bar appears at the bottom



- Use the arrow key to step to the right 2x to the CC icon. You do this with the ring around the "OK" key.

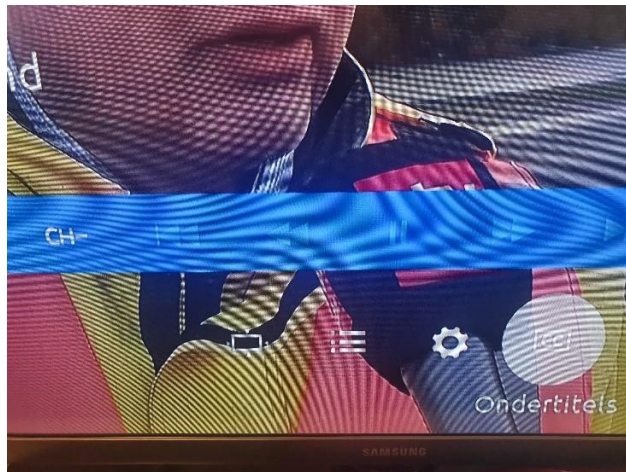

- Press the OK button 1x to activate subtitling.
- Finish with the "back" key.



Problems / Malfunctions

1. You will see the following or similar message on the TV:



- Check if the HDMI cable is properly connected; both on the settopbox and the TV.
- Check if the TV is set to the correct (external) HDMI input. This setting differs per TV. For Samsung TVs, press the "source" button on the TV remote control until the correct input is selected.
- Check if the settopbox is on, the standby LED is dimmed. When the LED is bright, the settopbox is off.

2. You will see the following message on the TV. In the top right corner of Internet, Ethernet and IP is in red letters "not available/connected"

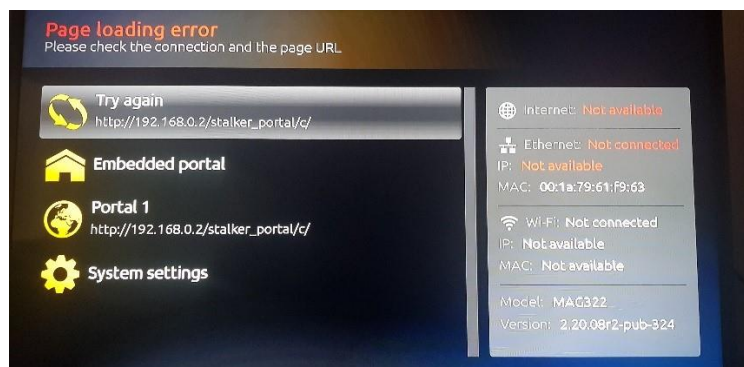

- Check if the RJ-45 Network Cable is properly connected; both on the settopbox and the relevant connection in the wall.
- Turn the settopbox off and on again. The standby LED lights dimly when the settopbox is on and bright when the settopbox is off.
- If the above screen reappears, contact the technical service.

- You will see the following message on the TV. The top right corner of the Internet says “not available”. In "Ethernet" and "IP", values are entered in white figures.

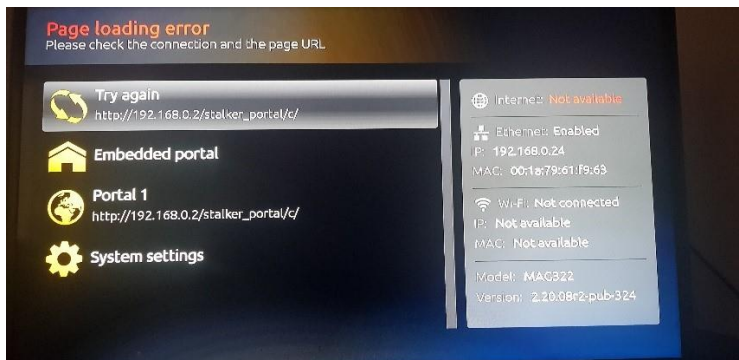

- Use the settopbox remote control to turn the unit off and on. The standby LED lights dimly when the settopbox is on, bright when the settopbox is off.
- If the screen reappears, select "Try again" with the settopbox remote control.
- If you see the above screen again, pull out the power plug of the settopbox and plug it back in after about 20 seconds. The settopbox will restart, this takes about 1 minute.
- If the screen reappears, contact the technical service.

- You see the following screen, but want to watch TV again.



- On the remote control of the settopbox, press the exit button (with the house symbol, at the top left of the ring).
- • Select “IPTV channels” with the arrow to the right.
- • Then press the "ok" key (in the middle of the ring).

5. The message “error playing content” appears in a red bar at the top of the screen. You will see the name of the channel, but no further picture.

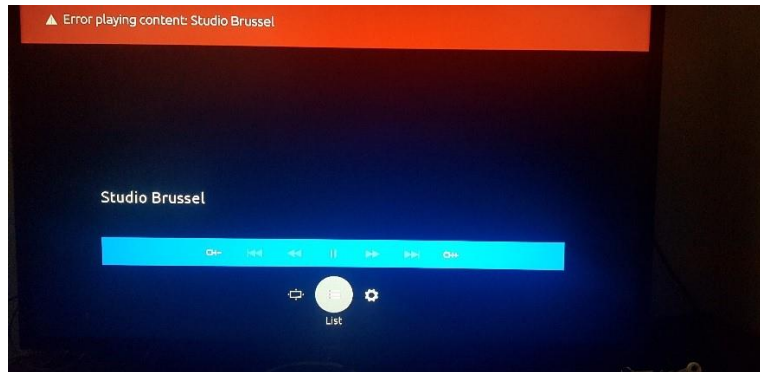

- Switch to a different station with the remote control of the settopbox, for example by pressing the "+" or "-" button on the "Chan" button.
 - If you do get an image, the relevant channel is temporarily unavailable.
 - If you get the red bar with the error message on all channels, there is a malfunction in the TV service. Inform the technical service.
6. There is no sound.
- Check whether the sound on the television is set to approx. 50% by adjusting the volume on the television with the television's remote control.
 - Increase the volume with the remote control settopbox.